

DRIVEWAY, CURB CUT AND / OR SIDEWALK PERMIT

FEE AMOUNT 0 DATE PAID 6-4-91 PERMIT NO. _____

OWNER Bert Poth CONTRACTOR Jerry Hesselshardt

ADDRESS 911 Graceway ADDRESS _____

PHONE () _____ PHONE () _____

DATE _____ CONTRACTOR'S REGISTRATION NO. _____

LOT _____ BLOCK _____ SUBDIVISION _____

PROJECT ADDRESS OF PROPOSED WORK Same

THIS WORK WILL BE COMPLETED BY THIS DATE _____

AGREEMENT (WORK SHALL NOT BEGIN UNTIL THE PERMIT IS RECEIVED)
I, _____ have applied to the City of Napoleon, Ohio for a permit to repair _____; reset _____; reconstruct _____; or construct _____; a _____ in the public right-of-way adjacent to _____ street for the purposes described in this application. In consideration of the City's issuance of the permit, I, as owner/contractor responsible for the work, do hereby agree as follows:

- 1) That all work, including barricading the work area to protect pedestrians and the traveling public, and all backfill and repair to pavement and lawn areas disturbed by the work, will be done in conformity with applicable law and regulations, specifically, the provisions of Napoleon Code, Chapter 90, and the regulations of the City Engineer.
- 2) That all work, as indicated above, will be performed in the time provided, and in conformity with lawful conditions, and standard drawings included in the permit, and to protect the public health, safety and welfare.
- 3) That I, as owner/contractor responsible for the work, hereby agree to indemnify the City of Napoleon, Ohio for all damage to its property, and hold the City harmless from all claims suits, losses, and expenses it may incur to persons not a party to the Agreement arising out of the activities of the applicant, his agent, employees, or contractors, in connection with a permit issued on the basis of this application.
- 4) That this Agreement shall not be construed as a limitation of the authority of the City Engineer to revoke this permit because of the applicant's or his agent's or contractor's failure to comply with state and local laws; regulations or conditions in this permit; or any other lawful basis of revocation.
- 5) That the statements made in the application are true and correct, to the best of my knowledge.

APPLICANT: Bert Poth DATE: 6-4-91

INSPECTED BY: _____ DATE: _____

NOTES:

TRANSITION FROM STANDARD:
CURB SECTION TO DROP CURB
SECTION TO BE MADE IN 18"
DISTANCE FROM DRIVEWAY EDGE

917 W. Graceway
9:30 AM

5" CURB BEYOND

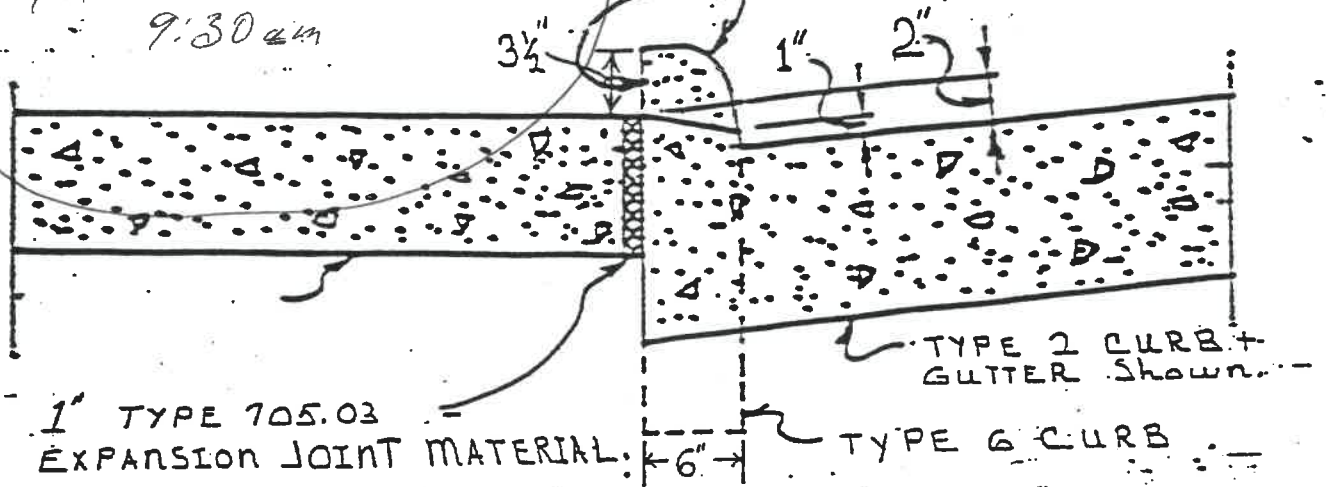

1" TYPE 705.03
EXPANSION JOINT MATERIAL: 6"

TYPE 2 CURB +
GUTTER SHOWN

TYPE 6 CURB

18" Edge of Driveway
CUT CURB AREA

1" Remaining Curb
GUTTER

ALL SIDEWALKS
CROSSING DRIVEWAYS
TO BE 6" THICK

1' off R/W

Right of Way Line

TRANSITION

60° MIN.

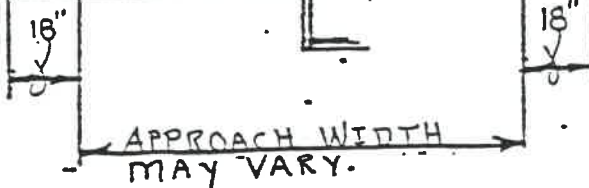

DROP CURB DETAIL AT DRIVEWAYS

I-25-89 CITY OF NAPOLEON, ENGINEERING DEPT DWG. No.